

222 - CAMARIM AUREA

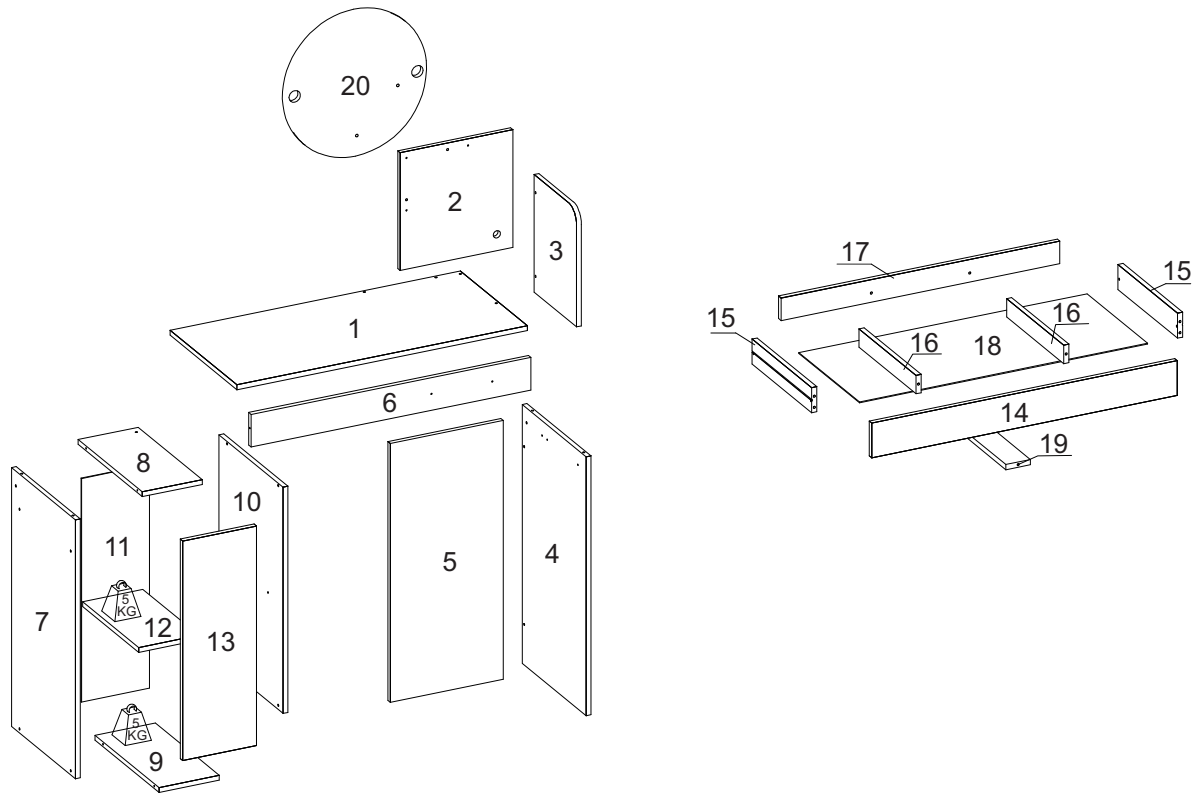

LISTA DE PEÇAS / Pieces List / Lista de Piezas

SEQ.	REF.	DESCRIÇÃO	DESCRIPTION	DESCRIPCIÓN	MAT.PRIMA	COMP.	LARG.	ESP.	QTD.
1	332042	Tampo	Top	Top	MDP	906	418	15	1
2	332043	Painel Traseiro Superior	Upper Rear Panel	Panel superior	MDP	359	352	15	1
3	332044	Lateral Direita Superior	Top Right Side	Lateral Direita Superior	MDP	360	265	15	1
4	332045	Lateral Direita	Right Side	Direita Lateral	MDP	792	400	15	1
5	332046	Painel Traseiro	Rear Panel	Panel Trasero	MDP	792	352	15	1
6	332047	Trava Traseira	Rear Lock	Esquerda	MDP	873	100	15	1
7	332048	Lateral Esquerda	Left Side	Lateral Esquerda	MDP	792	400	15	1
8	332049	Tampo Menor	Smaller top	Tapa menor	MDP	400	188	15	1
9	332050	Base	Base	Base	MDP	400	188	15	1
10	332051	Divisória	Divider	Separador	MDP	692	400	15	1
11	332052	Fundo	Bottom	Fondo	HDF	684	212	3	1
12	332053	Prateleira Móvel	Mobile Shelf	Estante Móvil	MDP	350	188	15	1
13	332054	Porta	Door	Puerta	MDP	672	230	15	1
14	332055	Frente De Gaveta	Drawer Front	Frente Cajón	MDP	897	100	15	1
15	332056	Lateral De Gaveta	Drawer Side	Lado del cajón	MDP	350	72	15	2
16	332057	Divisória Da Gaveta	Drawer divider	Separador del cajón	MDP	335	57	15	2
17	332058	Contra Fundo	Back	Parte trasera	MDP	818	65	15	1
18	332059	Fundo Da Gaveta	Drawer bottom	Fondo del cajón	HDF	846	355	3	1
19	332060	Apoio De Gaveta	Drawer support	Soporte del cajón	MDP	350	72	15	1
20	332061	Painel Espelho	Mirror panel	Panel de espejo	MDF	445	445	15	1

INSTRUÇÃO MONTAGEM PRODUTO
 Intructions to Assembly / Instrucciones de montaje

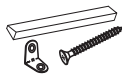

Separe as peças e acessórios de maneira organizada
 Separate parts and accessories in way organized
 Separe las piezas y accesorios de manera organizada

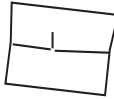

Forrar o chão com o papelão das embalagens.
 Cover the floor with the cardboard
 Cubra el suelo con la embalaje de cartón



É necessário 1 pessoa para montar o produto
 1 people are required to assemble the product
 Se requieren 1 persona para ensamblar el producto

O produto deve ser a montado por um profissional qualificado
 The product must be assembly by a professional
 El producto debe ser ensamblado por un profesional calificado

Ferramentas necessárias
 (não fornecidas)

Not include tools / No herramientas



CUIDADO PARA CONSERVAÇÃO E LIMPEZA DO MÓVEL
 Care to conservation and clean / Cuidados de limpieza

Peso máximo de carga informado refere-se a objetos distribuido de maneira uniforme sobre toda área de contato da peça



The maximum load weight informed refers to objects distributed evenly over the entire contact area of the part
 Conjunto de carga máxima de peso se refiere a objetos distribuidos uniformemente sobre toda el área de contacto de la pieza de trabajo.



Não molhar o móvel e não expor em lugar úmido
 Do not wet the mobile and do not expose in a wet place
 No moje el producto y no exponer en un lugar húmedo



Não expor o móvel próximo de fontes de calor.
 Do not expose the mobile near heat sources
 no exponga cercano de fuentes de calor



Não usar produtos abrasivos.
 Do not use abrasive products.
 No utilice productos abrasivos.



Limpe com flanela limpa e seca.
 Clean with dry cloth
 Limpieza con un paño limpio y seco

LISTA DE ACESSÓRIOS E FERRAGENS / ACCESSORIES AND HARDWARE / ACCESORIOS Y HARDWARE

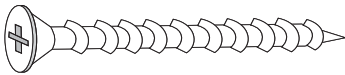

A- 700137-Parafuso 4,5x45 (21x)
 screw / tornillo



B- 700124 - Parafuso 3,5x25 (7x)
 screw / tornillo



C- 700121-Parafuso 3,5x12 (52x)
 screw / tornillo



D- 700127 - Parafuso 4,0x12 (24x)
 screw / tornillo



E- 700130-Parafuso 4,0x16 (4x)
 screw / tornillo



F- 700157-Prego (36x)
 nail / clavo



G- 700542-Cavilha 6x30 (11x)
 peg / cerrojo

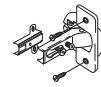

H- 700396 - Dobradiça (02x)
 700389 - Calço (02x)
 hinge / bisagra



I- 700538-Cantoneira (1x)
 corner / esquina



J- 700539-Cantoneira (4x)
 corner / esquina



K- 700419-Tapa furo minifix (16x)
 cover / tapa



L - 700114-Corrediça (1x)
 runners / corredera



M- 700440-Suporte Prateleira (02x)
 Shelf support / soporte



N- 700441-Suporte prateleira(04x)
 shelf support/soporte de estanteria



O- 700448-Sapata 'L' (08x)
 shoe / zapata



P- 701157-Suporte triangular (04x)
 Triangular support / Soporte triangular

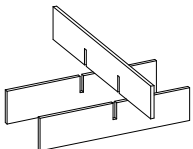

Q- 703146-Divisor joias(02x)
 jewelry divider /
 divisor de joyas

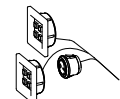

R- 700628-kit luminaria(01x)
 light kit / kit de luz



S- 703145 - Espelho (01x)
 Mirror / Espejo



T- 700516-Sache cola 20g (01x)
 Glue / Goma



U - 701352 - Parafuso 3,5x30 (3x)
 screw / tornillo

01° PASSO - Fixar os acessórios nas peças 4 e 7.

01° STEP - Fix the accessories to parts 4 and 7.

01° PASO - Fijar los accesorios a las piezas 4 y 7.

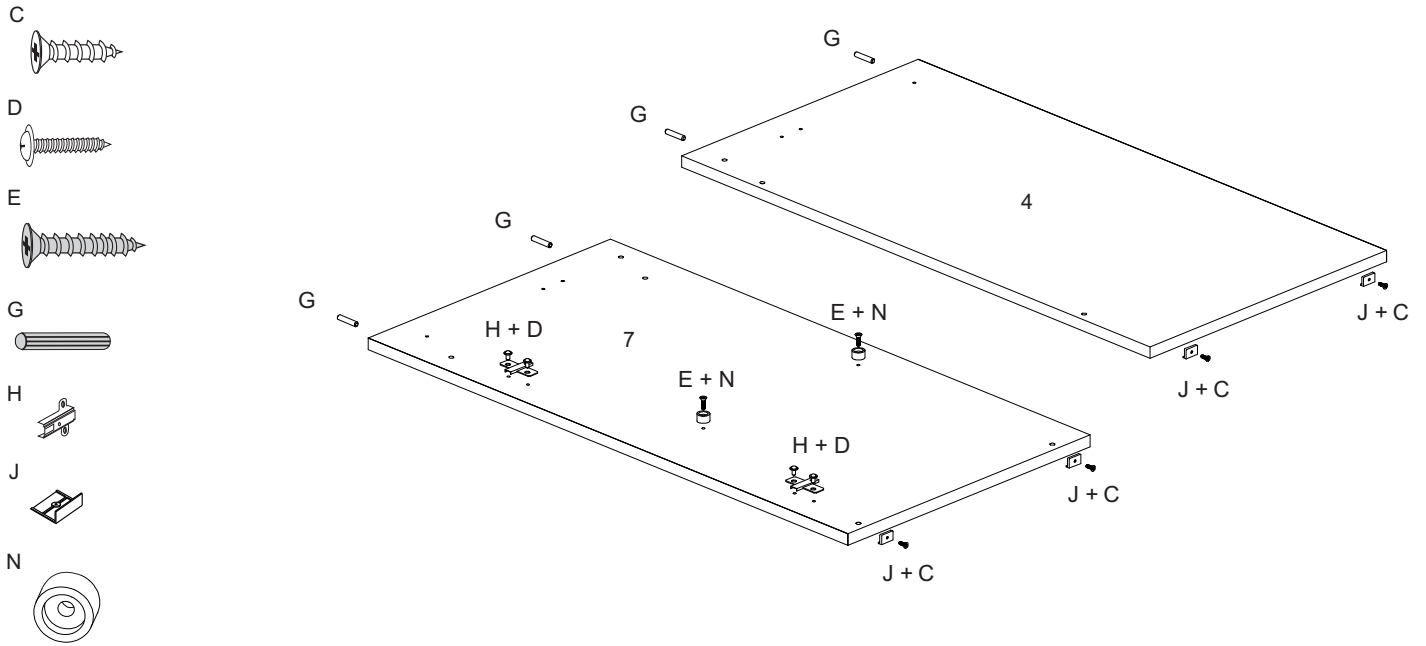

02° PASSO - Fixar os acessórios nas peças 5 e 10.

02° STEP - Fix the accessories to parts 5 and 10.

02° PASO - Fijar los accesorios a las piezas 5 y 10.

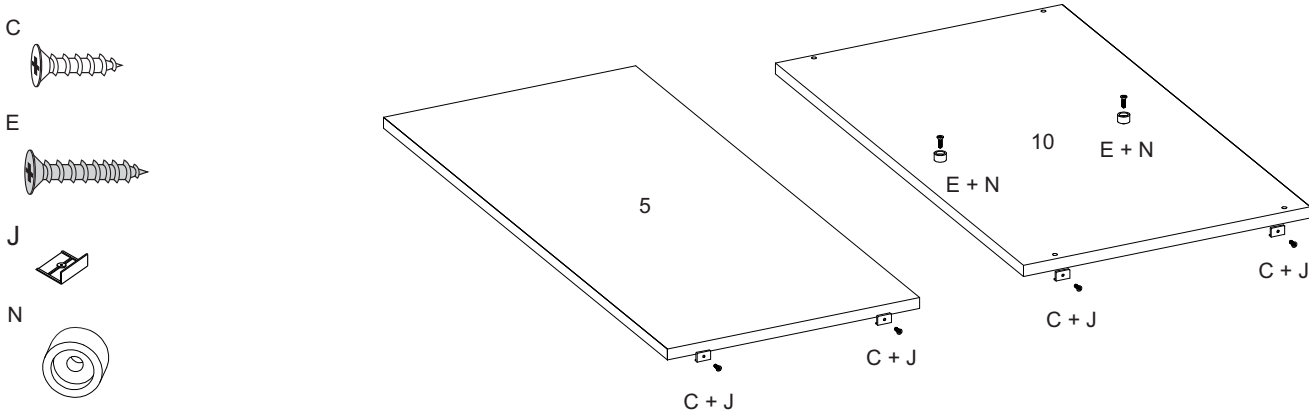

03° PASSO - Fixar a peça 3 na peça 2 utilizando o acessório A.

03° PASO - Fix part 3 to part 2 using accessory A.

03° STEP - Fijar la pieza 3 a la pieza 2 con el accesorio A.

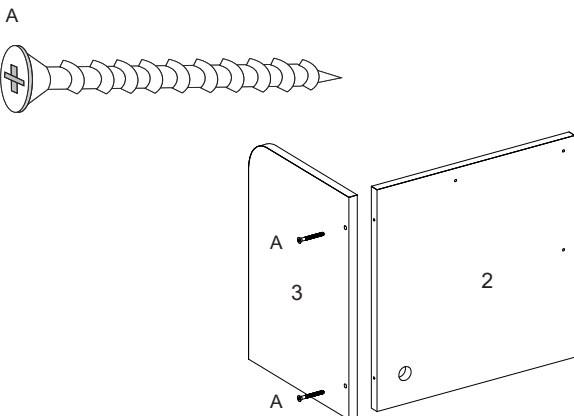

04° PASSO - Fixar a peça 1 nas peças 2 e 3 utilizando o acessório A.

04° PASO - Fix part 1 to parts 2 and 3 using accessory A.

04° STEP - Fijar la parte 1 a las partes 2 y 3 utilizando el accesorio A.

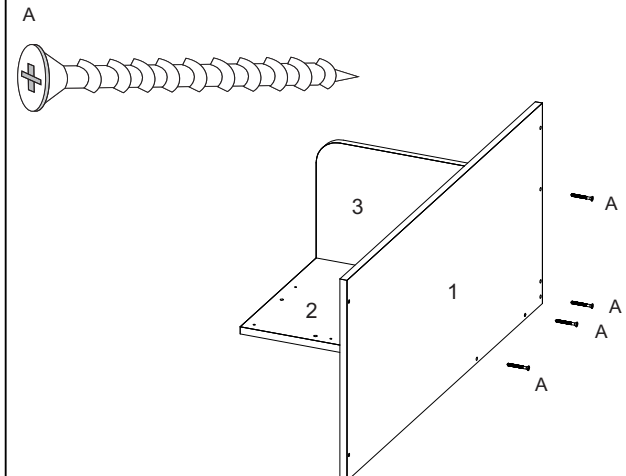

05° PASSO - Fixar a peça 4 na peça 5 utilizando o acessório A.

05° STEP - Fix part 4 to part 5 using accessory A.

05° PASO - Fijar la pieza 4 a la pieza 5 utilizando el accesorio A.

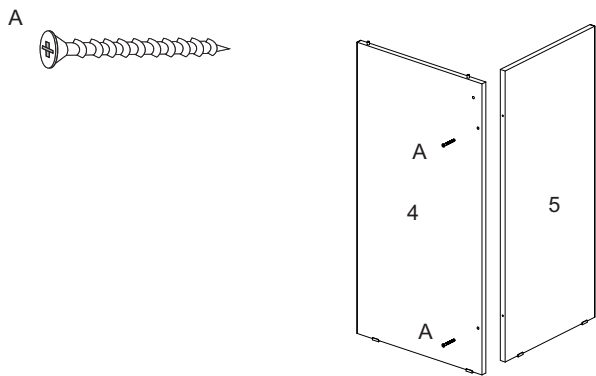

06° PASSO - Fixar a peça 6 nas peças 4 e 5 utilizando o acessório A e B.

06° STEP - Fix part 6 to parts 4 and 5 using accessory A and B.

06° PASO - Fijar la pieza 6 a las piezas 4 y 5 utilizando los accesorios A y B.

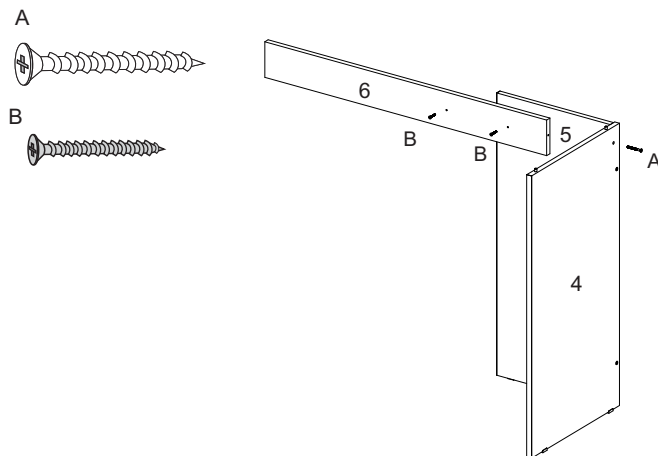

07° PASSO - Fixar a peça 7 na peça 6 utilizando o acessório A.

07° STEP - Fix part 7 to part 6 using accessory A.

07° PASO - Fijar la pieza 7 a la pieza 6 utilizando el accesorio A.

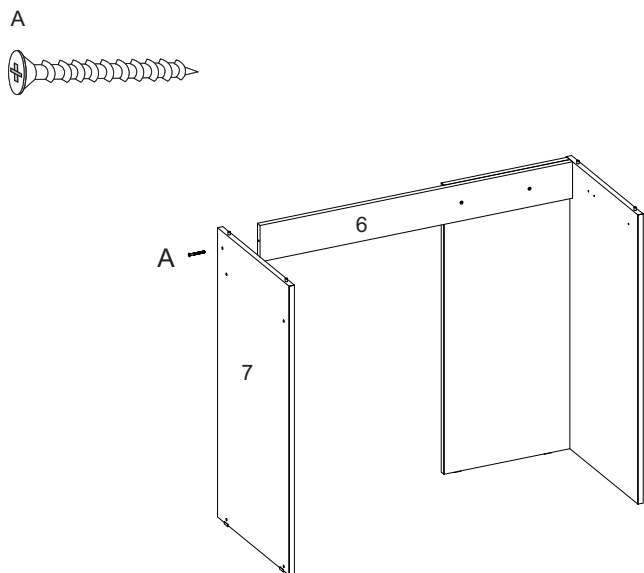

08° PASSO - Fixar a peça 1 nas peças 4, 6 e 7 utilizando o acessório B + J.

08° STEP - Fix part 1 to parts 4, 6 and 7 using accessory B + J.

08° PASO - Fijar la pieza 1 a las piezas 4, 6 y 7 utilizando el accesorio B + J.

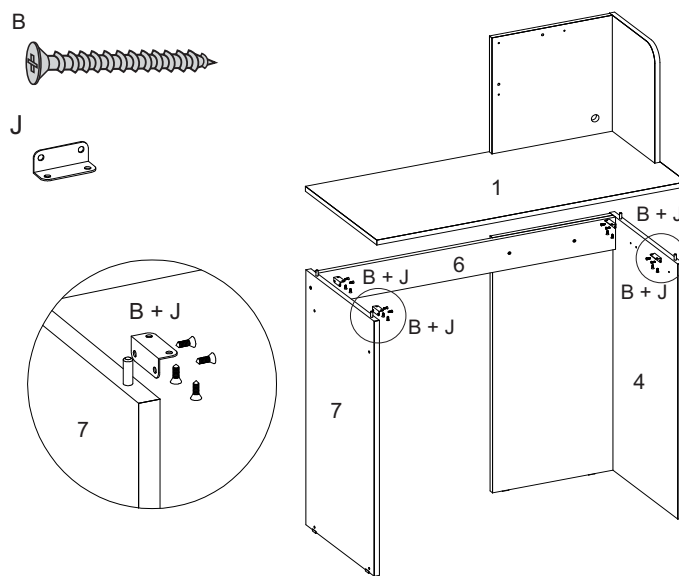

09° PASSO - Fixar a peça 8 nas peças 6 e 7 e peça 9 na peça 7 utilizando o acessório A.

09° STEP - Fix part 8 to parts 6 and 7 and part 9 to part 7 using accessory A.

09° PASO - Fijar la pieza 8 a las piezas 6 y 7 y la pieza 9 a la pieza 7 utilizando el accesorio A.

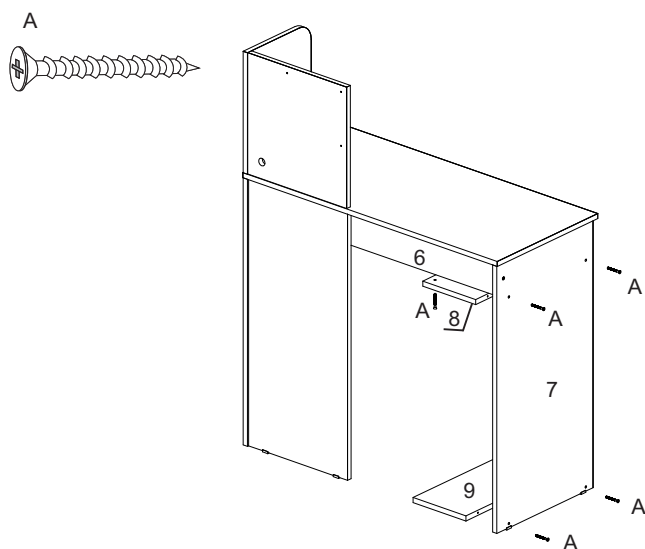

10° PASSO - Fixar a peça 10 nas peças 8 e 9 utilizando o acessório A.

10° STEP - Fix part 10 to parts 8 and 9 using accessory A.

10° PASO - Fijar la pieza 10 a las piezas 8 y 9 utilizando el accesorio A.

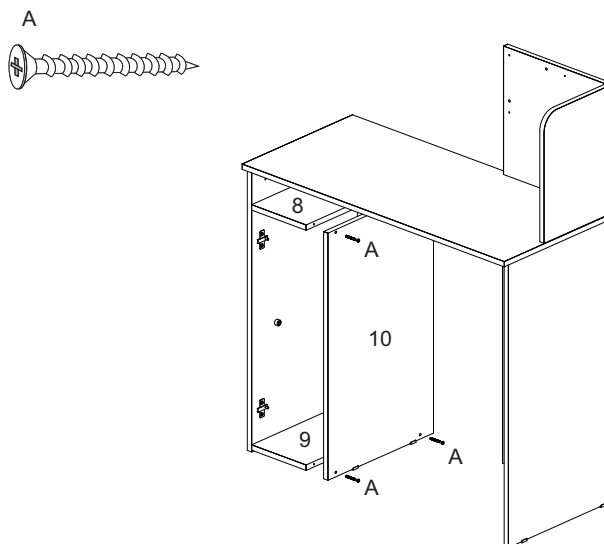

11° PASSO - Fixar a peça 11 atrás do produto utilizando o acessório F.

11° STEP - Fix part 11 behind the product using accessory F.

11° PASO - Fijar la pieza 11 detrás del producto utilizando el accesorio F.

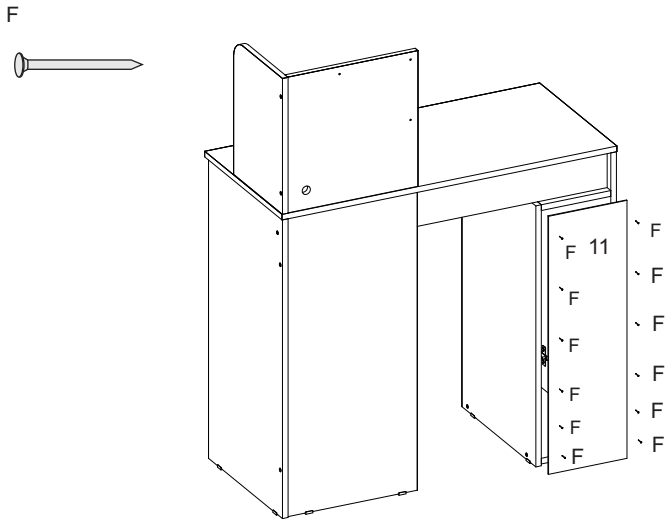

12° PASSO - Apoiar a peça 12 sobre o acessório N.

12° STEP - Support part 12 on accessory N.

12° PASO - Apoya la parte 12 en el accesorio N.

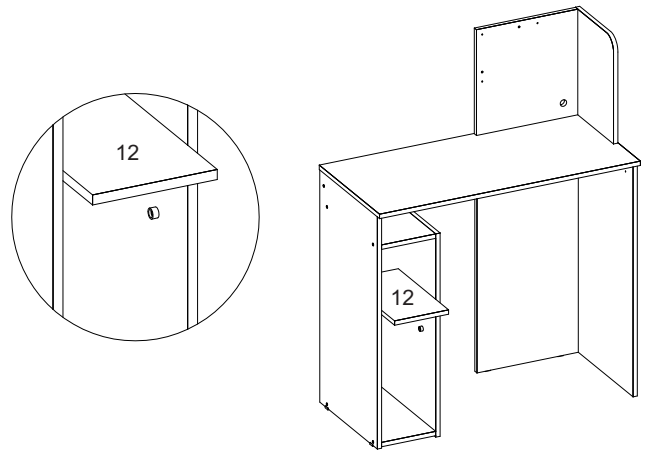

13° PASSO - Fixar os acessórios D+ H na peça 13.

13° STEP - Fix fittings D+ H to part 13.

13° PASO - Fijar los racores D+ H a la pieza 13.

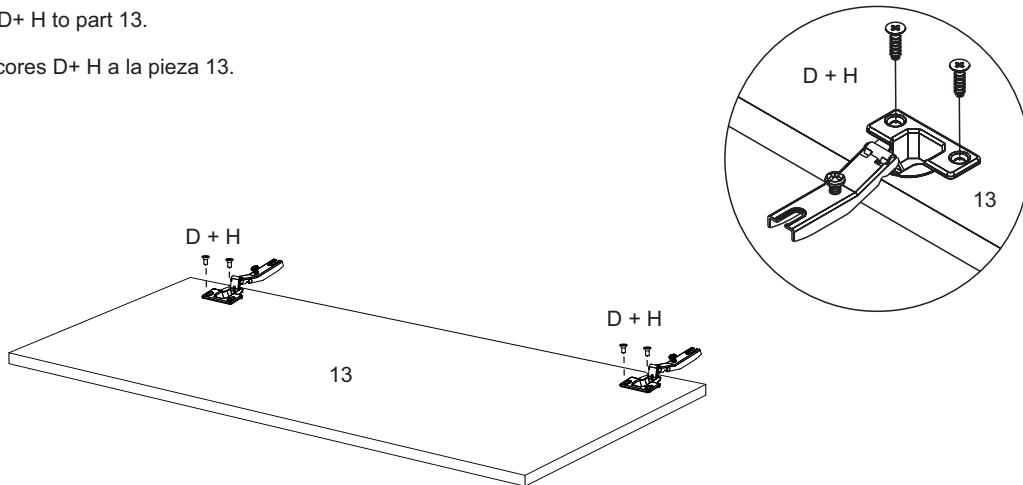
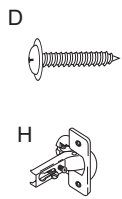

14° PASSO - Encaixar a peça 13 junto com a peça 7 utilizando o acessório H.

14° STEP - Fit part 13 together with part 7 using accessory H. Fit part 13 together with part 7 using accessory H.

14° PASO - Unir la pieza 13 con la pieza 7 mediante el herraje en H.

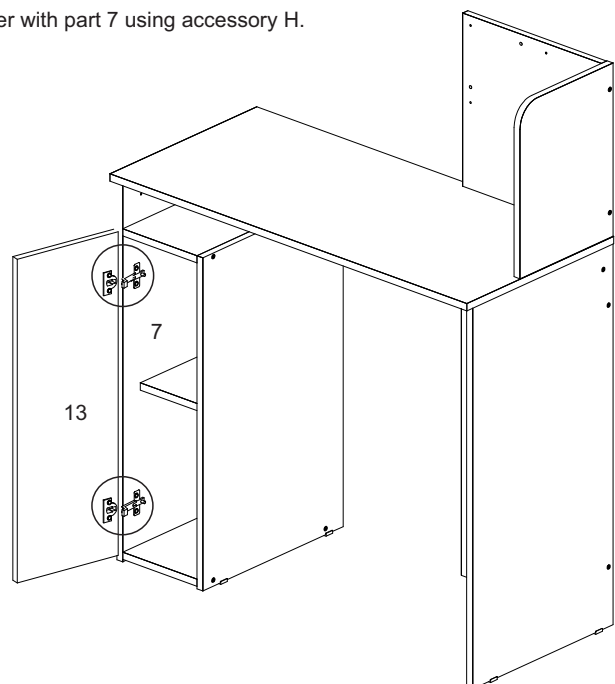
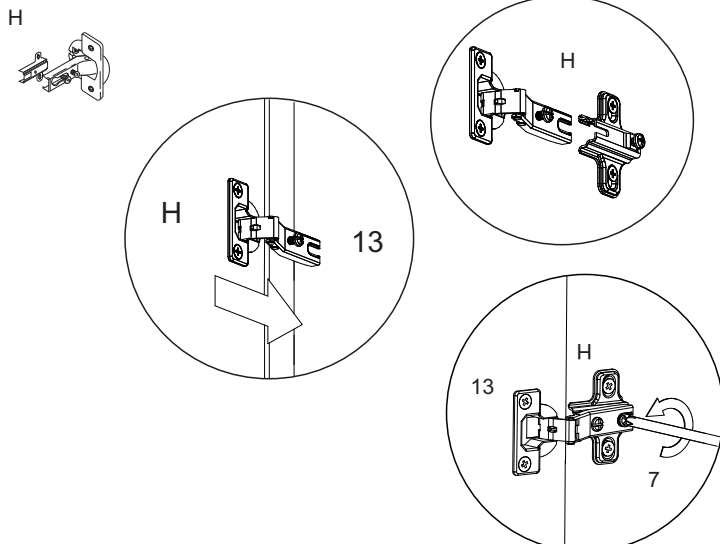

15° PASSO - Fixar o acessório C + L nas peças 4 e 7.

15° STEP - Fix accessory C + L to parts 4 and 7.

15° PASO - Fije el accesorio C + L a las piezas 4 y 7.

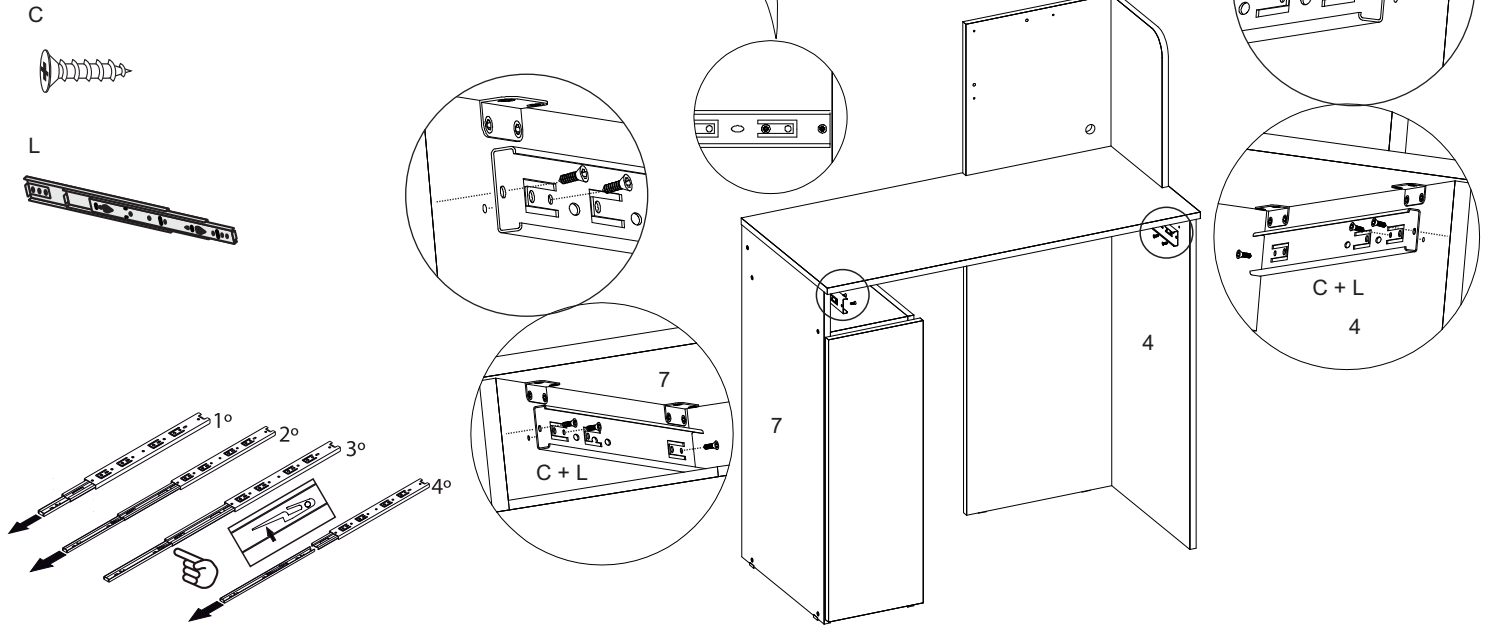

16° PASSO - Fixar as peças 15 e 16 na peça 14, fixar peça 17 nas peças 15 e 16.

16° STEP - Fix parts 15 and 16 to part 14, attach part 17 to parts 15 and 16.

16° PASO - Fijar las partes 15 y 16 a la parte 14, unir la parte 17 a las partes 15 y 16.

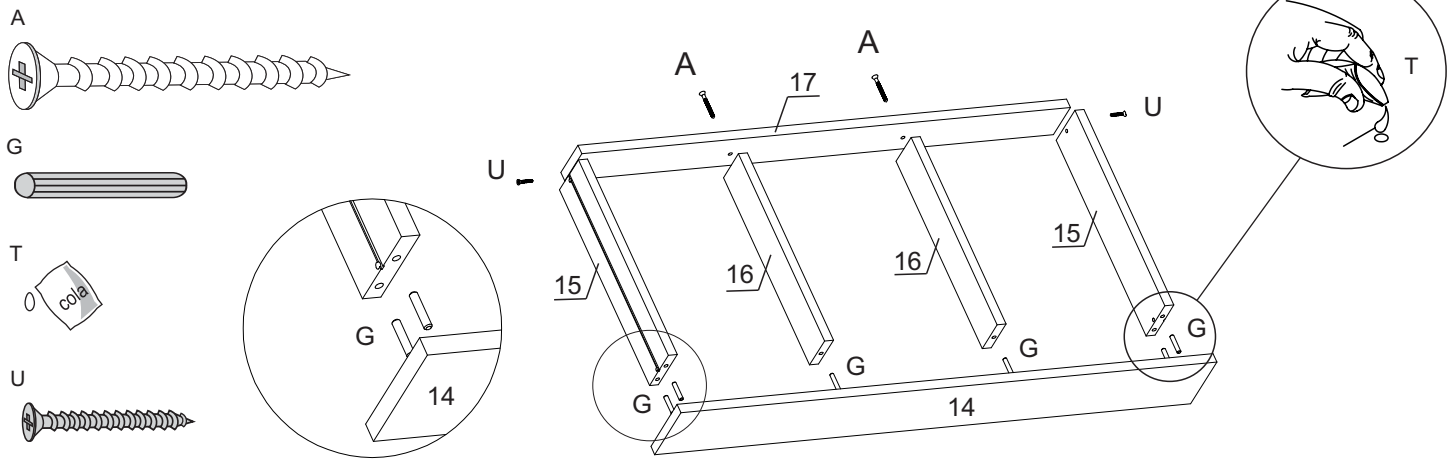

17° PASSO - Fixar o acessório D + P nas peças 14, 15 e 16.

17° STEP - Fix accessory D + P to parts 14, 15 and 16.

17° PASO - Fijar el accesorio D + P a las piezas 14, 15 y 16.

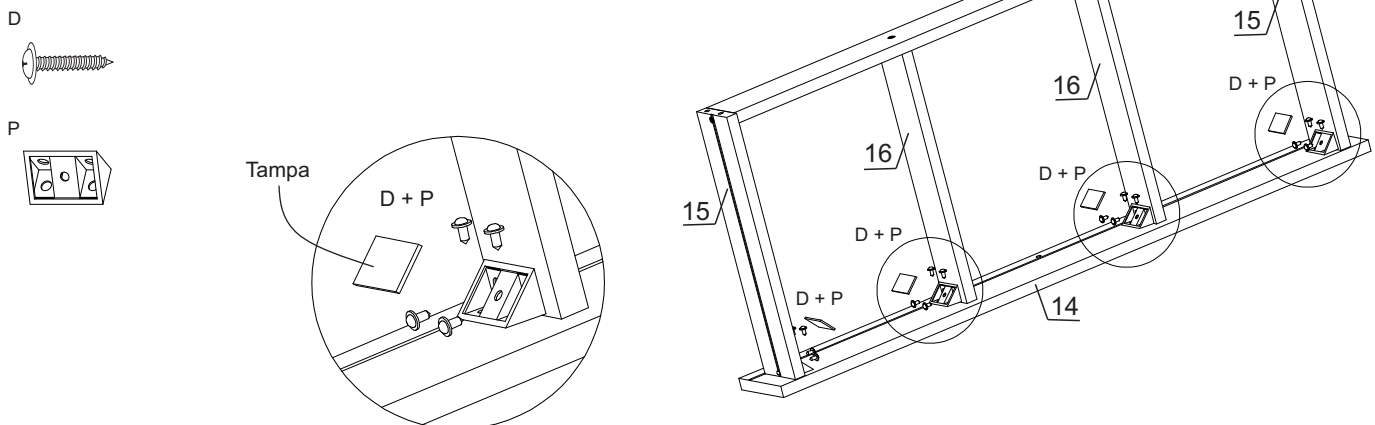

18° PASSO - Fixar a peça 18 embaixo da gaveta com os acessórios C + F.

18° STEP - Fix part 18 under the drawer with fittings C + F.

18° PASO - Fijar la pieza 18 debajo del cajón con los herrajes C + F.

C



F

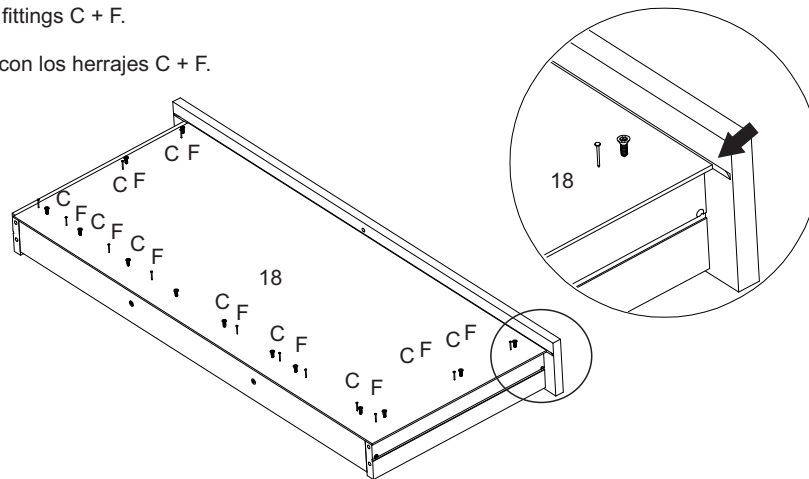

19° PASSO - Fixar a peça 19 na peça 18 e fixar o acessório C + L na peça 15.

19° STEP - Fix part 19 to part 18 and attach accessory C + L to part 15.

19° PASO - Fije la pieza 19 a la pieza 18 y fije el accesorio C + L a la pieza 15.

C



G



I



L



U

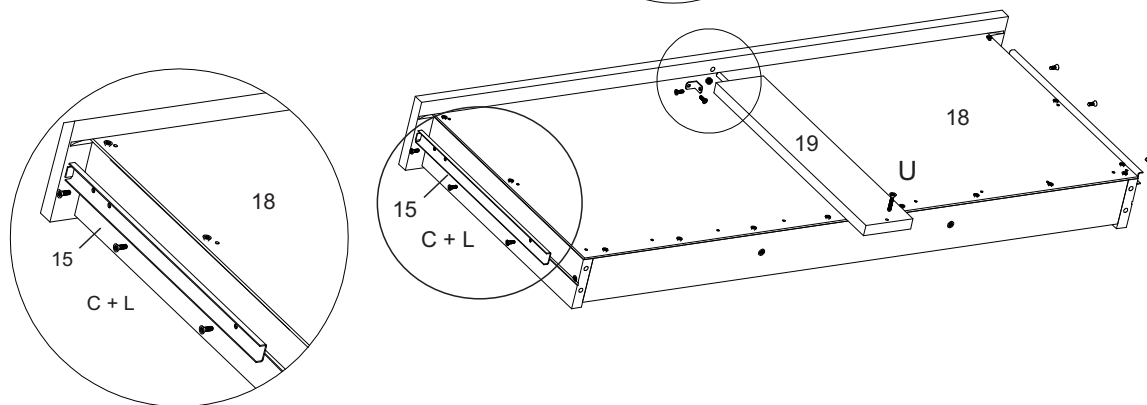
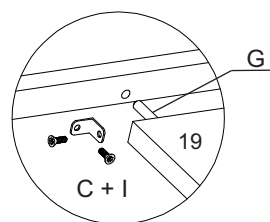

20° PASSO - Encaixar acessório Q entre as peças 15 e 16.

20° STEP - Fit accessory Q between parts 15 and 16.

20° PASO - Coloque el accesorio Q entre las piezas 15 y 16.

Q

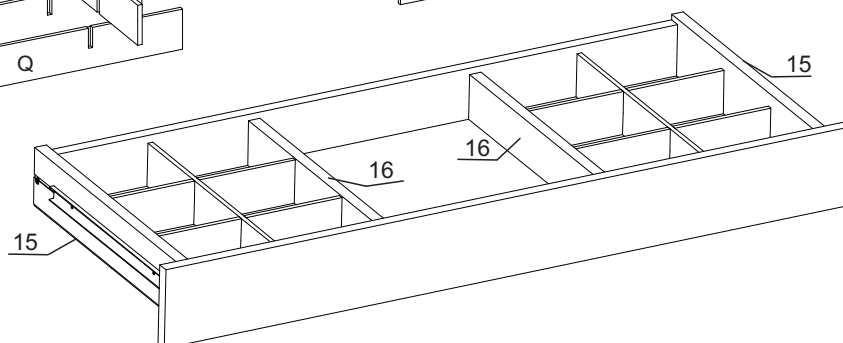
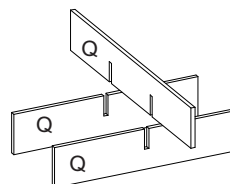
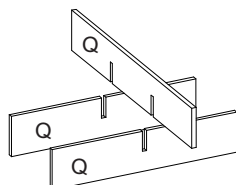
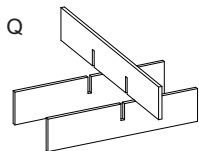

21° PASSO - Encaixar Gavetas no Produto.

21° STEP - Fitting drawers into the product.

21° PASO - Colocación de cajones en el producto.

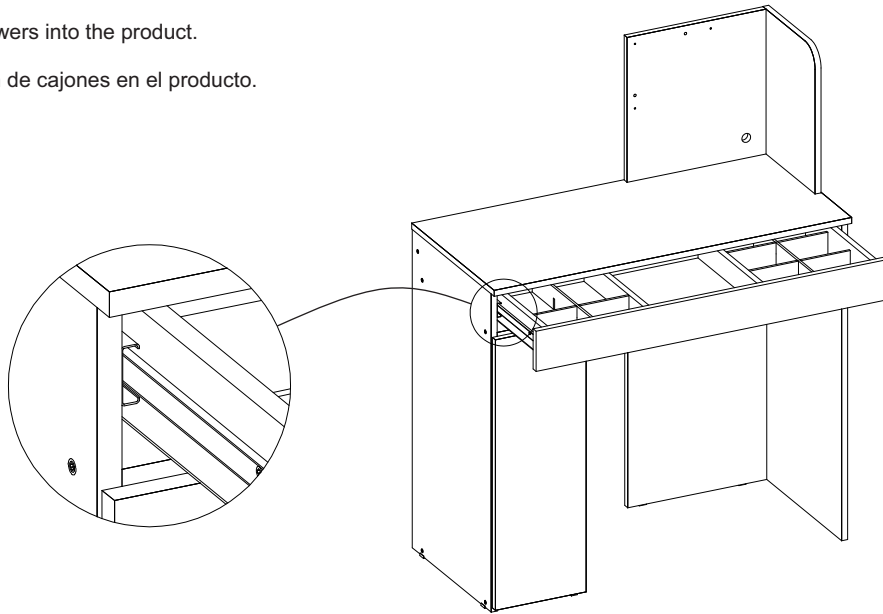

22° PASSO - Fixar o acessório M na peça2.

22° STEP - Fix accessory M to part2.

22° PASO - Fijar el accesorio M a la pieza2.

M

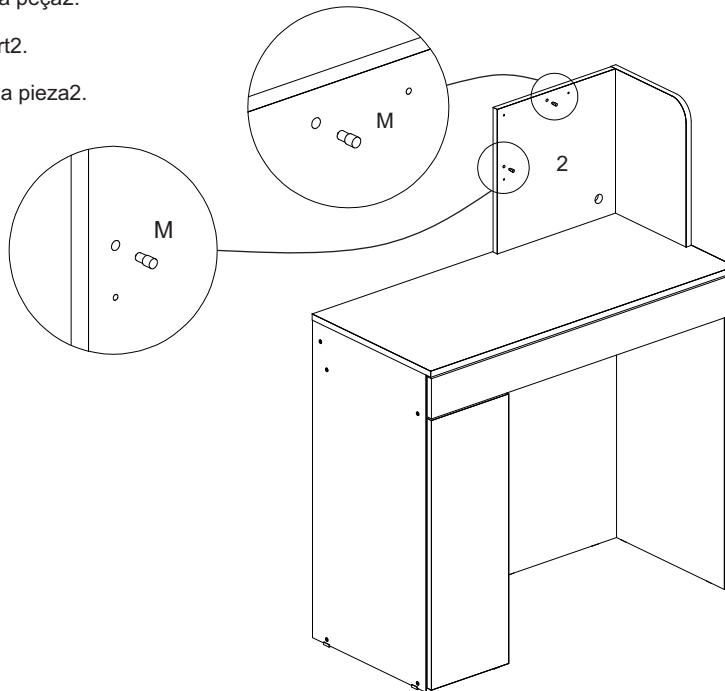

23° PASSO - Fixar a peça 20 na peça 2 utilizando o acessório B.

23° STEP - Fix part 20 to part 2 using accessory B.

23° PASO - Fijar la pieza 20 a la pieza 2 con el accesorio B.

B

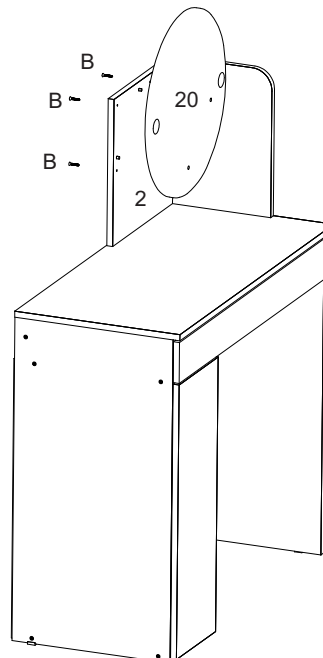

24° PASSO - Encaixar o acessório R nas peças 2 e 20.

24° STEP - Fit accessory R to parts 2 and 20.

24° PASO - Montar el accesorio R en las piezas 2 y 20.

R

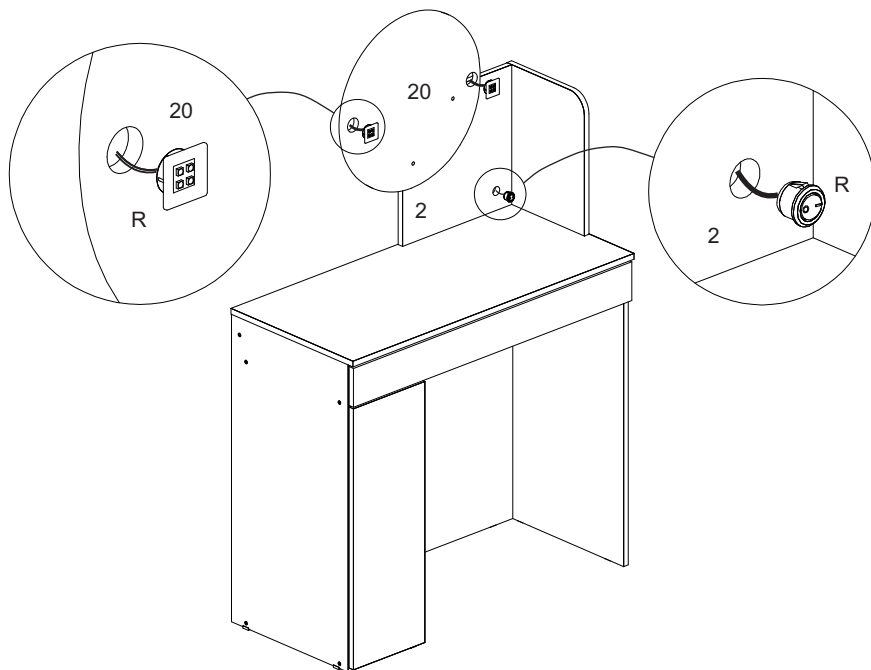
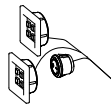

25° PASSO - Colar espelho com Fitas Dupla Face na peça 20.

25° STEP - Mirror necklace with double-sided tape on piece 20.

25° PASO - Collar espejo con cinta adhesiva de doble cara en la pieza 20.

S

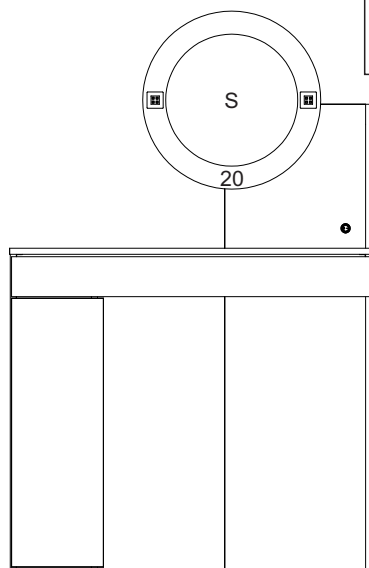

Atenção / Watch / Atencion

Antes de colar o espelho. Favor, limpar a superfície da peça com um pano seco

Before gluing the mirror. Please clean the surface of the piece with a dry cloth

Antes de pegar el espejo Por favor, limpie la superficie de la pieza con un paño seco

ASPECTO FINAL DO PRODUTO

FINAL APPEARANCE OF THE PRODUCT

ASPECTO FINAL DEL PRODUCTO

